

Hip Joint Fitting Patented.

The new and innovative design of Hip Joint fitting allows for increased freedom of movement with no negative effects on airflow. The Double Swivels and MID Rotating Joint allow for an unrestricted range of movement. The tool user can therefore perform more efficiently by using the tool optimally and with less fatigue.

This product is manufactured from hardened steel material with a durable and corrosion resistance coating. It is a tough and durable products.

- Complete and free rotation 360°
- Bends freely to 45°
- Free movement even when pressurized
- Designed for use with Pneumatic Tools
- Allows hose to fall freely and reduce hose weight for user
- Tough and durable steel material
- Can withstand vibration

Media	Compressed Air
Working Pressure	1 Mpa for compressed air
Working Temperature	0 – 60 degree C
Metal in use	Steel (SCM)
Sealing in use	NBR

2HJ-N2M-N2F

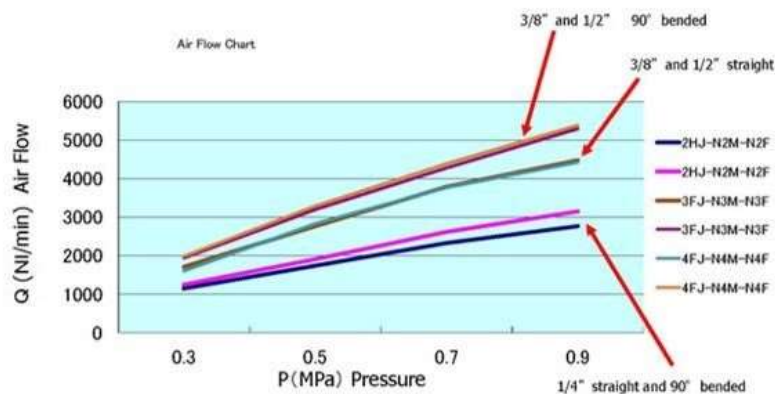

Inner Diameter
2HJ
3HJ
4HJ

Thread (A)		
None	2M	R 1/4
None	3M	R 3/8
None	4M	R 1/2
N	2M	NPT 1/4
N	3M	NPT 3/8
N	4M	NPT 1/2

Thread (B)		
None	2F	Rc 1/4
None	3F	Rc 3/8
None	4F	Rc 1/2
N	2F	NPTF 1/4
N	3F	NPTF 1/4
N	4F	NPTF 1/4
P	Japanese Plug	



Male & Female

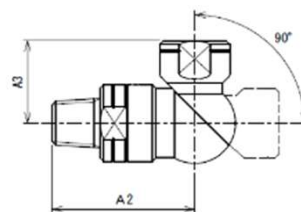
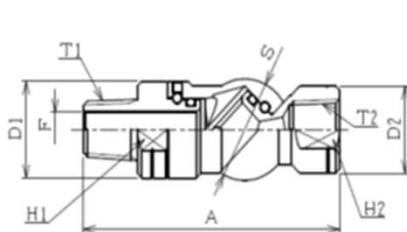

Model	T1	T2	A	A2	A3	F	H1	H2	D1	D2	S	Weight(g)
2HJ-MF	R1/4	R1/4	61	39	22.5	7.5	19	17	21	19	22	88
2HJ-NMF	NPT1/4	NPT1/4	61	39	22.5	7.5	19	17	21	19	22	88
3HJ-MF	R3/8	R3/8	73	43	30	9.5	24	24	26	26	27	174
3HJ-NMF	NPT3/8	NPT3/8	73	43	30	9.5	24	24	26	26	27	174
4HJ-MF	R1/2	R1/2	73	43	30	9.5	24	24	26	26	27	164
4HJ-NMF	NPT1/2	NPT1/2	73	43	30	9.5	24	24	26	26	27	164

Male & Male

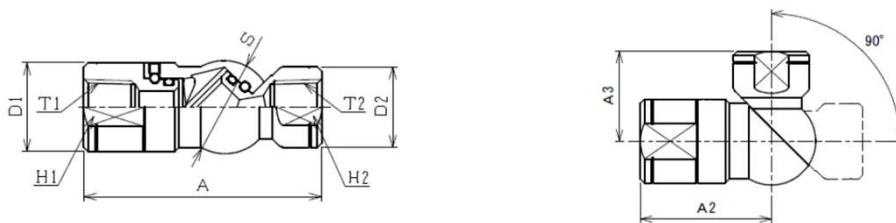

Model	T1	T2	A	A2	A3	H1	H2	D1	D2	S	Weight(g)
2HJ-FF	Rc1/4	Rc1/4	55	33	22.5	19	17	21	19	22	90
2HJ-NFF	NPT1/4	NPT1/4	55	33	22.5	19	17	21	19	22	90
3HJ-FF	Rc3/8	Rc3/8	66	38	30	24	24	26	26	27	154
3HJ-NFF	NPT3/8	NPT3/8	66	38	30	24	24	26	26	27	154
4HJ-FF	Rc1/2	Rc1/2	68	38	30	24	24	26	26	27	144
4HJ-NFF	NPT1/2	NPT1/2	68	38	30	24	24	26	26	27	144

Asian Standard Plug Male Thread

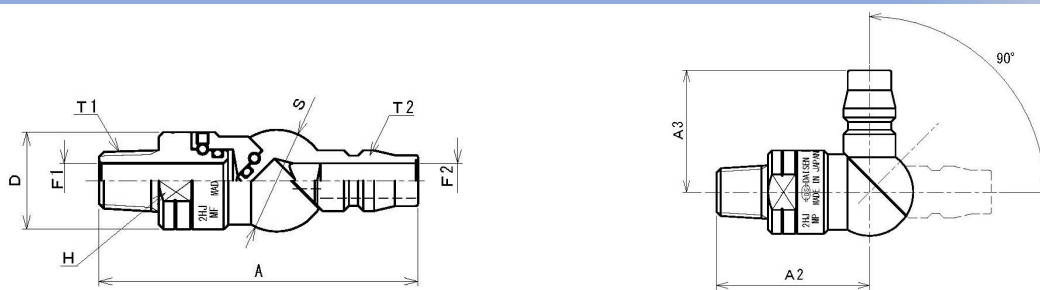

Model	T1	T2	A	A2	A3	F	H	D1	D2	S	Weight(g)
2HJ-MP	R1/4	Asian STD	82	39	44	7.5	19	21	19	22	104